

with or without Limit Values

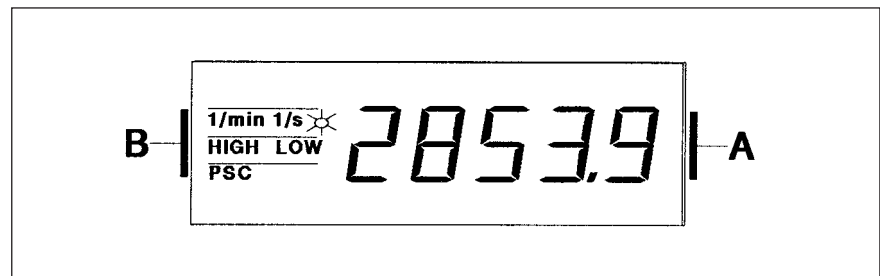

- Frequency range 1/min ... 10 000/s
- 2 limit values can be preset
- Large 5-digit LED display, digit height 14 mm
- Prescaler range 0.001 ... 9.999 can be expanded with pre-divisor
- Programmable start-up suppression
- Simple operation
- DIN dimensions 48 x 96 mm
- Plug-in screw terminals

DISPLAY



A 5-digit LED display for speed indication.
 0.00 indicates standstill of pulse generator (machine)
 ---- indicates display overflow

B LED indicators show program steps and unit of measurement.

PROGRAMMING

Input level 1:

A variety of programming options is available on three input levels.

Provides access to program steps in which numeric values can be requested and entered.

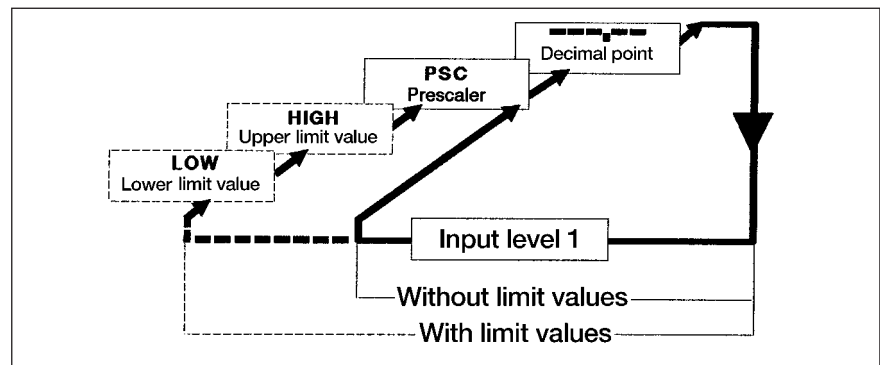

Type 722

Technical data

Input level 2:

Programming of equipment/machine-specific parameters.

		Program switches			
		S1	S2	S3	S4
min. frequency	$\geq 60 \frac{1}{\text{min}}$	OFF	OFF		
	$\geq 10 \frac{1}{\text{min}}$	ON	OFF		
	$\geq 1 \frac{1}{\text{min}}$	OFF	ON		
Display range	$\frac{1}{\text{min}}$			OFF	
	$\frac{1}{\text{s}}$			ON	
Input	max.30 Hz				ON
	max 10 kHz				OFF

Input level 3:

Alteration of the factory-set standard functions pre-divisor and start-up suppression.

UNIT OF MEASUREMENT

Tachometers signo 722 can be used for registration of almost any time-related measuring dimensions. In consideration of the wide range of different measurement units, a decal foil with the most common units is provided to label the tachometer.

TECHNICAL DATA

Display	5-digit, LED, programmable decimal point
Digit height	14 mm
Supply voltage V_{op}	12 ... 24 VDC - 5 % + 10 %, 24 VAC + 10 % 100 ... 240 VAC + 10 %, depending on version
Current consumption	on 12 ... 24 VDC < 300 mA, on 24 VAC < 200 mA, on 100 ... 240 VAC < 150 mA
Sensor supply	AC versions 24 VDC, max. 60 mA DC versions V_{op} - 2 V max. 60 mA
Measuring time	one period at $f < 4$ Hz, periods of $T = 250$ ms at $f > 4$ Hz
Measuring accuracy	0.01 % + 1 digit
Refresh time	approx. 1 second
Value retention	approx. 10 years, NV RAM (no battery)
Operating temperature	0 ... + 50 °C
Storage temperature	- 20 ... + 70 °C
Electrical connection	plug-in screw terminals
Mounting	clamping frame
Protection class (IEC 144)	front IP 54, connections IP 20
Interference immunity EMC	severity 3 acc. to IEC 0801 - pt. 2 + pt. 4
General design	acc. to DIN VDE 0411; protection class II
Input	
Amplitude thresholds	< 2 V and > 8 VDC, max. + 40 V
Active edge	positive
Pulse shape	random (squarewave 1:1 for max. frequency)
Input resistance	5 k Ω
Count input	
Counting frequency range	1/min ... 10 000/s
Control inputs	
Keylock	static
Display memory	static
Outputs	depending on version
Signal outputs	OUT-LOW and OUT-HIGH
Relays	
Contact type	changeover contacts with snubber
Switching voltage	max. 50 VDC/250 VAC ref. to ground
Switching current	max. 1 A

Type 722

Technical data

CONNECTION DIAGRAM

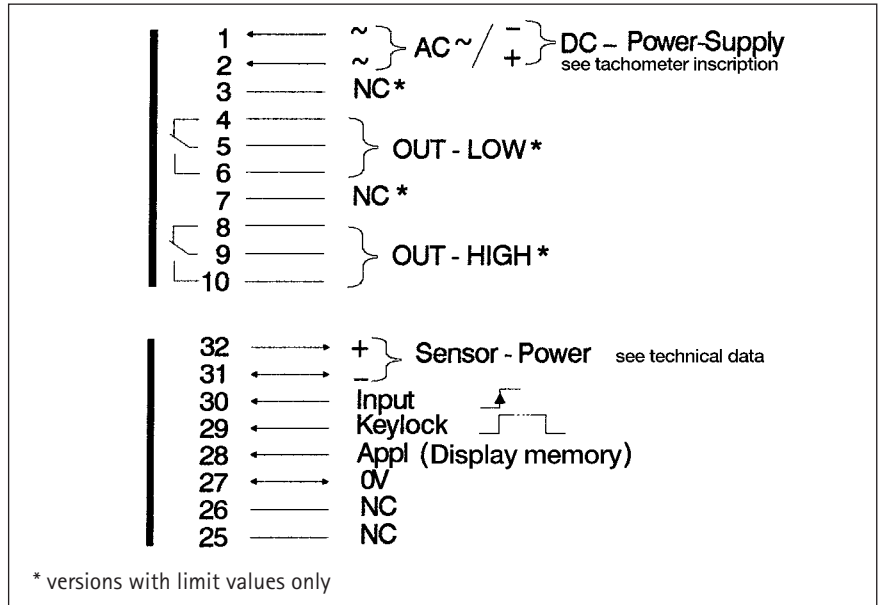

DIMENSIONED DRAWING

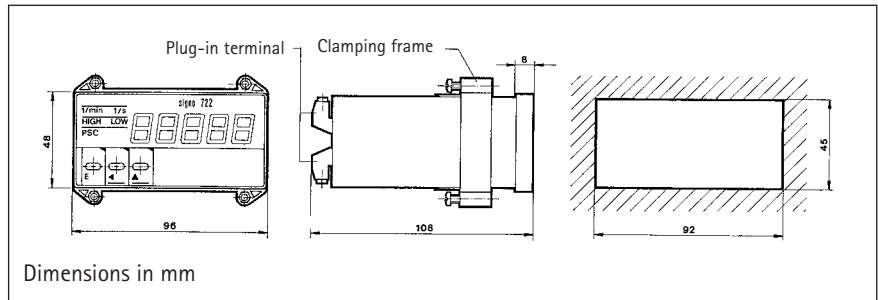

ORDER INFORMATION

Tachometer

Accessories

	Ordering code 12 ... 24 VDC	Ordering code 24 VAC	Ordering code 100 ... 240 VAC
Tachometer without limit value	0 722 201	0 722 203	0 722 202
Tachometer with limit values	0 722 101	0 722 103	0 722 102
Adapter panel frame 125 x 60 mm (cutout 106 x 55 mm)			1 405 679